

Hand Control

Push/Pull Brake/Accelerator

If you are unable to operate the foot pedals, this adaptation allows you to operate the brake and accelerator by hand using a push/pull single lever.

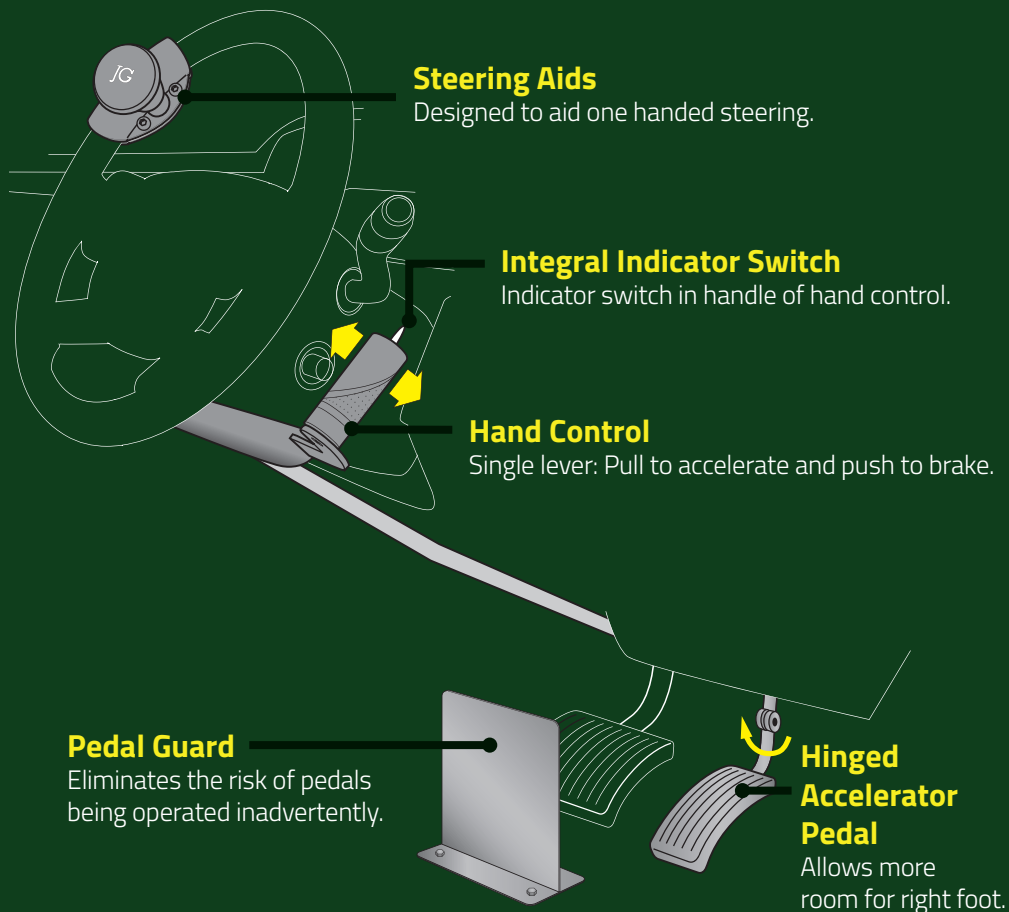

Hand Control

Push/Pull Brake/Accelerator



Push/Pull Brake Accelerator

To brake, simply **push down** on the handle using either the palm of the hand or fingertips

Smooth acceleration is achieved by placing your thumb around the steering wheel and **squeezing** the handle with your fingers

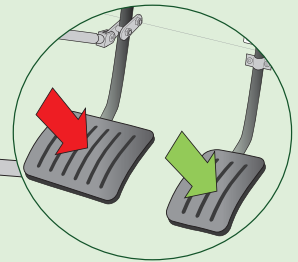

A True Driving Experience

Using precision components and axial roller bearings, our hand controls offer the driver unrivalled smooth and responsive operation.

If you are new to driving with hand controls we strongly recommend installation of the following items: Push/pull brake/accelerator with integral indicator switch, hinged accelerator (where possible) and a steering aid.



Indicator switch

Integral Indicator Switch

Hand controls are available with an integral indicator switch in the handle. When driving with hand controls, your right hand will be operating the brake/accelerator lever and your left hand will be required for steering, therefore you may find it difficult to operate the indicators with the vehicle's standard indicator stalk.

N.B. This is usually a requirement for drivers taking their test with hand controls.

Multiplex/Non-Multiplex Indicators?

You may hear the term multiplex or non-multiplex indicators. This refers to the vehicle's wiring system. The indicator switch will look identical and function in exactly the same way. However, the indicator switch is more complex to install on multiplex vehicles and is significantly more expensive*.

**All integral indicator switches (both multiplex and non-multiplex) are available at £NIL cost to Motability customers when installed at the start of your lease.*

Steering Aids

Ball/Peg/Tetra-grip



Ball (Fixed or Quick Release)

The most commonly used steering aid, the steering ball is grasped from the front using a partially clenched hand. Available in fixed or quick release versions.



Tetra-grip (Quick Release)

The tetra grip is controlled by placing the wrist between two adjustable supports and fingers around the peg. Available as quick release only.



Peg (Quick Release)

The steering peg is grasped from the side using a partially clenched hand. Available as quick release only.

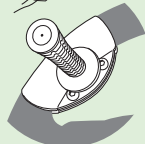

Quick-release operation

The quick release mechanism is operated by pushing the pin at the back of the steering aid and sliding out the handle.

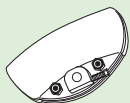

Hinged Accelerator Pedal

By folding up the accelerator pedal out of the way you will have more room for your right foot. This provides the additional space you may need if you have a prosthetic or fused right leg. It also offers you a more comfortable driving position. In order to keep your feet clear of the pedals, many hand control drivers adapt an unnatural driving position which can lead to discomfort. Driving with a hinged accelerator pedal folded up out of the way, will give you more room for your right leg and you will be able to adopt a safer, more comfortable driving position.

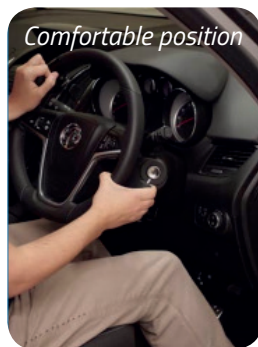
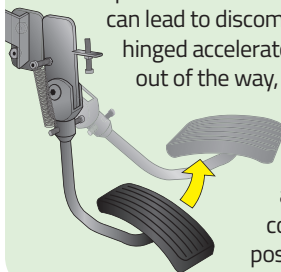

Pedal Guard

Available as standard (as shown) or single Brake or Accelerator only versions. You can remove the pedal guard easily by unfastening the wing nuts and detaching the guard.



The hinged accelerator pedal and pedal guard are not suitable for all vehicles. **To check compatibility call our support team on 0161 430 2151**



Frequently Asked Questions

Q: Can hand controls be fitted to any vehicle or is my choice limited?

A: Jeff Gosling hand controls can be fitted to any vehicle, although we strongly recommend you choose a conventional automatic. We currently have a design for almost 1,400 different models of vehicle. If your chosen vehicle is not on our list we can design the controls for you at our workshop. Although we will need your vehicle for several days to do the design and installation, there is no additional charge to you for the design work. The hinged accelerator pedal and pedal guard are not suitable for all vehicles. Call us to check compatibility.

Q: Will the fitting of hand controls cause any damage to my vehicle?

A: Safety is our primary concern when we design adaptations, however we pay great attention to the integrity of the vehicle. Any cutting or drilling is kept to a minimum, ensuring an aesthetically pleasing result and minimum cost to reinstate the vehicle when the adaptations are removed.

Q: Can someone else drive the vehicle with their feet when the hand controls have been fitted?

A: Yes, we do not remove any of the original controls. However we recommend that you make the driver aware that the adaptations have been fitted.

Q: Can I adjust my steering column after the hand controls have been fitted?

A: For most vehicles the answer will be no. By adjusting the steering column you may affect the function of the brake/accelerator hand control. If the steering column position requires adjustment you will need to contact your hand control installer.

Q: Can I set my steering column position before the hand controls are fitted?

A: Yes, we recommend that you do this if the position is critical for you. Some vehicles have a limited range and therefore we suggest you discuss this with your installer before your hand controls are fitted.

Q: What if I decide I want indicators in my hand control after they have been fitted?

A: It is possible to fit an indicator switch retrospectively, although it is more expensive than if the indicator switch had been included at the time of the original fitting because your hand control will have to be partially dismantled to enable the wiring to be connected. Indicator switches are only available at £Nil cost to Motability customers when ordered and fitted prior to 'handover' of the vehicle.

Tel: +44 (0)161 430 2151 Enquiries: info@jeffgosling.co.uk

 /JeffGoslingHC  /JGHCLtd

www.jeffgosling.co.uk